



**A.D. PRODUZIONE SRL**

+39 02 33 50 24 97

info@adproduzione.it

www.adproduzione.com

**SPREMIPELLE - mod. SPC21M - SPC21E**

Unità di misura: cm

## ESEMPIO DI OPERE MURARIE

PER LE SPECIFICHE CHIEDERE AL PROPRIO PROFESSIONISTA EDILE

- 1) Sabbia lavata
- 2) Magrone - Spessore 10 cm con rete elettrosaldada diam.5 mm
- 3) Piano calpestabile - Pavimentazione come vostro piazzale
- 4) cls r' ck 250kg/cm<sup>2</sup>
- 5) Tubo di scarico acqua diametro 60 mm p.v.c. (prevedere la pendenza del tubo per favorire lo scarico dell'acqua)
- 6) Tubo 1/2" con valvola a saracinesca - Arrivo acqua dalla rete min. 3 bar

In caso di Pedale Elettrico e Termoresistenza (optional):

- 7) Tubo diametro 50 mm p.v.c. per passaggio cavo elettrico tipo P+N+T sez 2,5 mm (il cavo deve fuoriuscire di minimo 1 m per il collegamento elettrico)
- 8) Obbligo di messa a terra - Punto di connessione di terra della struttura (la corda deve fuoriuscire di 1 metro dalla pavimentazione)

### ATTENZIONE

- Interventi da verificare in base alle condizioni geotecniche del terreno.
- I collegamenti elettrici eseguiti durante l'installazione dovranno garantire le normative vigenti.
- Potenza installata ,in caso di Pedale Elettrico e Termoresistenza (optional): 500 W (230 V).
- I cavi elettrici non devono subire: torsioni, accavallamenti e sfregamenti contro spigoli vivi.
- Tutti gli arrivi dei tubi devono sporgere di 20 cm.

--- INGOMBRO MACCHINA

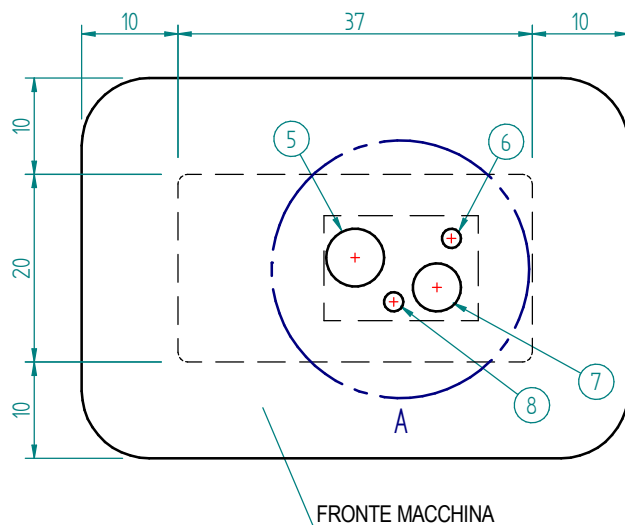

FRONTE MACCHINA

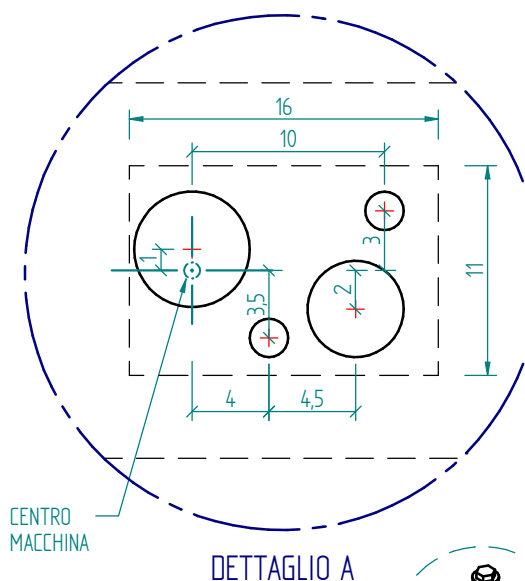

CENTRO MACCHINA

DETTAGLIO A

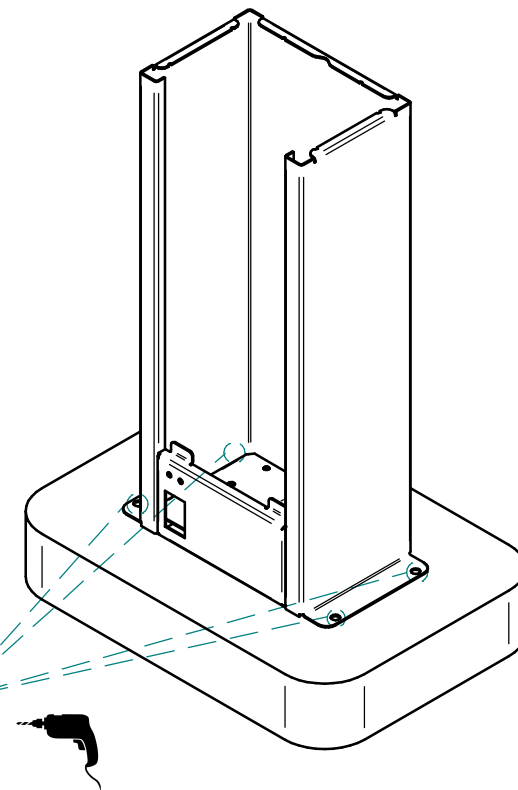
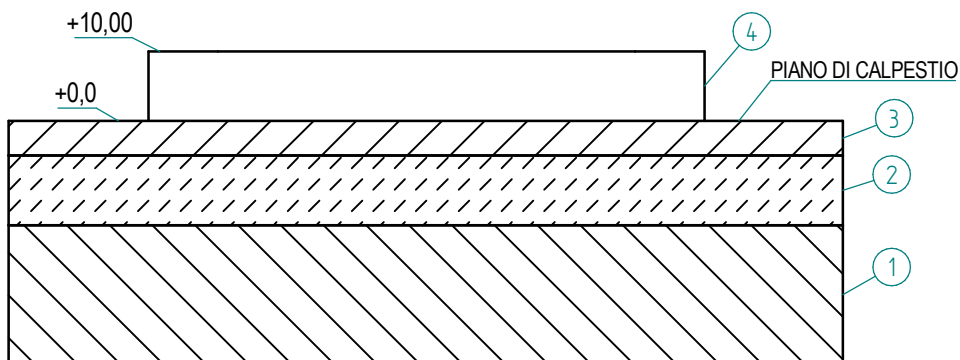

 <p><b>A.D. PRODUZIONE SRL</b> +39 02 33 50 24 97 info@adproduzione.it www.adproduzione.com</p>	
	<p><b>ESSORER DE CUIR mod. SPC21M - SPC21E</b></p>
<p>Unité de mesure: cm</p>	

# EXEMPLE DE TRAVAUX DE MAÇONNERIE

Pour les spécifications, demandez à votre professionnel de la construction

- 1) Sable lavé
- 2) Maçon épaisseur 10 cm avec maille soudée diam. 5 mm
- 3) Surface au sol - Plancher selon Votre parvis
- 4) csl r' ck 250 kg./cm<sup>2</sup>
- 5) Tuyau de vidange d'eau diam. 60 mm p.v.c. (prévoir la pente du tuyau pour favoriser l'écoulement de l'eau)
- 6) Tuyau 1/2" avec vanne d'arrêt - l'eau vient du réseau min. 3 bar

En cas de pédale électrique et thermorésistance (en option) :

- 7) Tuyau diam. 50 mm p.v.c. pour le passage du câble électrique tipe P+N+T sect. 2,5 mm (le câble doit sortir de minimum 1 mètre pour le câblage électrique)
- 8) Mise à la terre - Point de connexion de terre de la structure (la corde doit sortir de minimum 1 mètre du revêtement de sol)

## ATTENTION

- Intervention à vérifier en fonction des conditions géotechniques du terrain.
- Les liaisons électriques faites pendant l'installation devront respecter les normes en vigueur.
- Puissance installée, en cas de pédale électrique et thermorésistance (en option) : 500 W (230 V).
- Les câbles électriques ne doivent pas subir de torsions, de chevauchements et de frottements contre les bords vifs.
- Toutes les tubes des arrivées doivent dépasser de 20 cm.

--- DIMENSION MACHINE

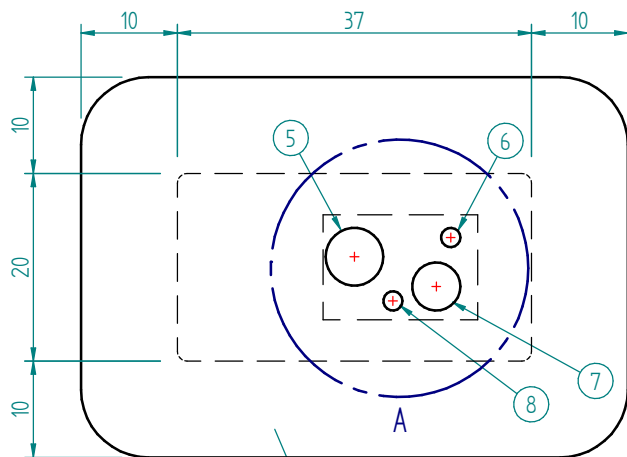

FAÇADE DE LA MACHINE

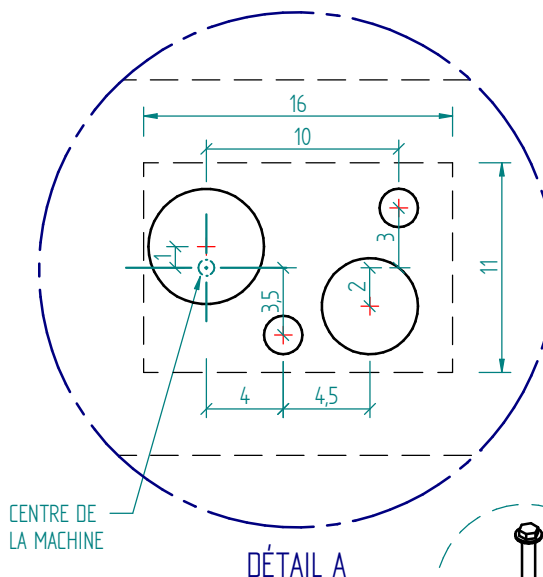
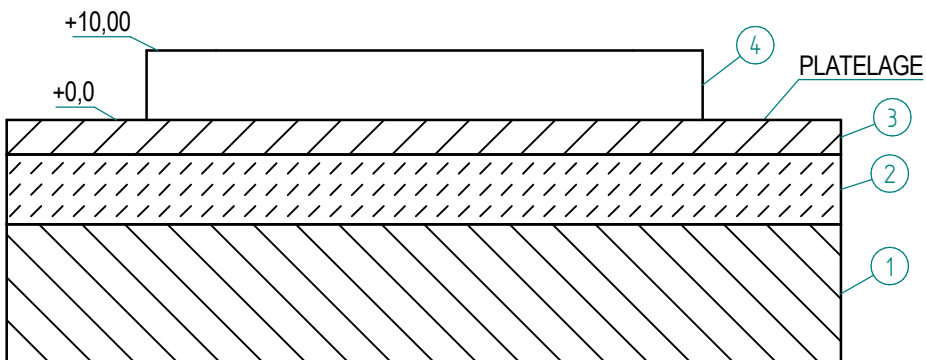

CENTRE DE LA MACHINE

DÉTAIL A

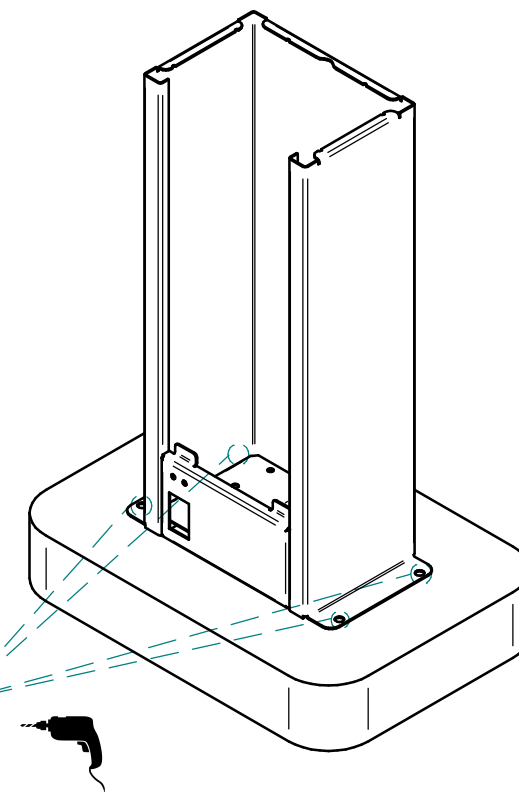
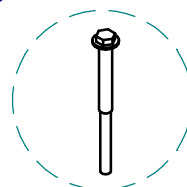



**A.D. PRODUZIONE SRL**

+39 02 33 50 24 97

info@adproduzione.it

www.adproduzione.com

**LEATHER SQUEEZER - mod. SPC21M - SPC21E**

Unite of measure: cm

--- MACHINE MAIN DIMENSIONS

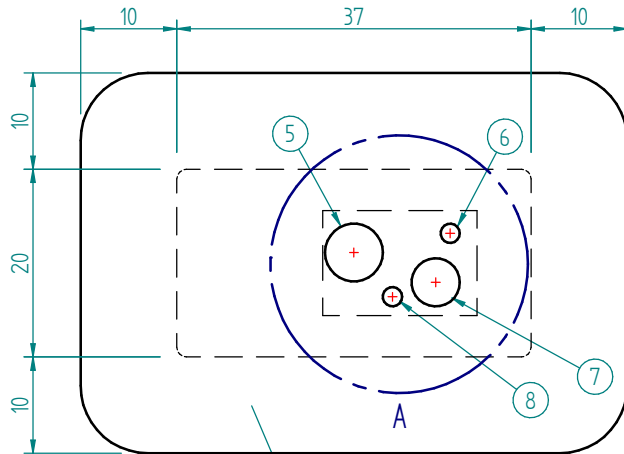

FRONT OF THE MACHINE

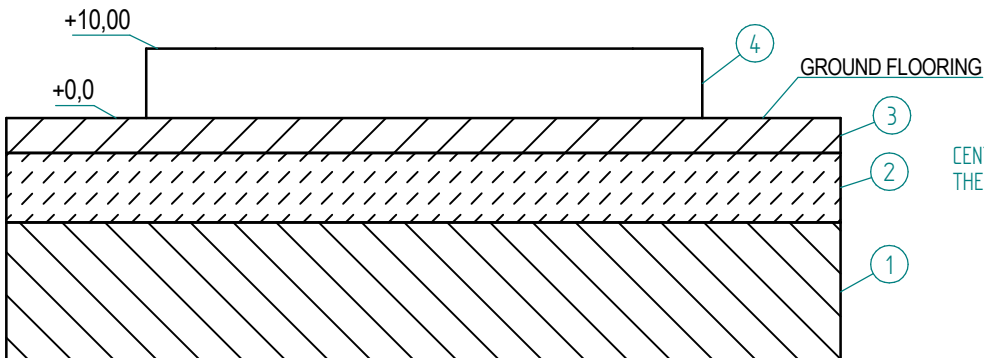

## EXAMPLE OF MASONRY WORKS

FOR TECHNICAL DETAILS ASK TO A PROFESSIONAL TECHNICIAN

- 1) Washed sand
  - 2) Lean concrete with 10 cm thickness with 5 mm diameter welded mesh
  - 3) Walkable floor - Flooring as per your forecourt
  - 4) cls r' ck 250 kg/cm<sup>2</sup>
  - 5) 60 mm diameter water exhaust p.v.c. tube (preparing tube slope to help water drainage)
  - 6) 1/2" tube with gate valve - incoming water with min. pressure 3 bar
- If you have the electrical pedal and the antifreeze system (optional):
- 7) 50 mm diameter p.v.c. hose for the passage of the P+N+T type electric cable section 2,5 mm (the cable must come out at least 1 meter out of the flooring to allow the electrical connection)
  - 8) Grounding obligation - Ground connection point of the structure (the cord must come out by 1 m from the flooring)

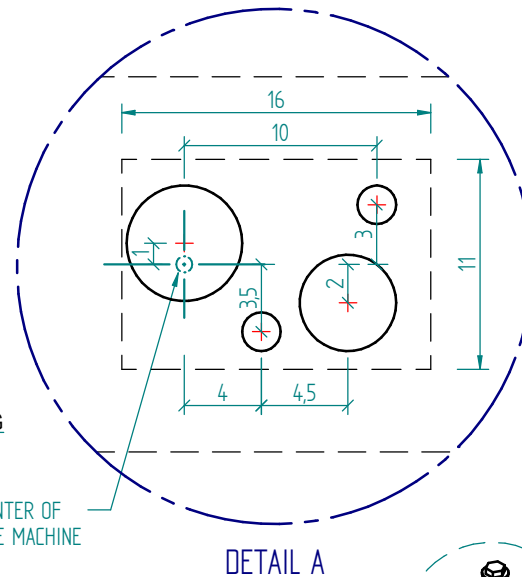

CENTER OF THE MACHINE

DETAIL A

### CAUTION

- Interventions to be checked in accordance with geotechnical conditions of soil.
- Electrical connections made during installation must ensure the regulations in force.
- Installed power, if you have the electrical pedal and the antifreeze system (optional): 500 W (230 V).
- Electrical cables must not be twisted, overlapping and rubbing against sharpe edge.
- All the extremities of the tubes must stick out by 20 cm.

